

G1a*

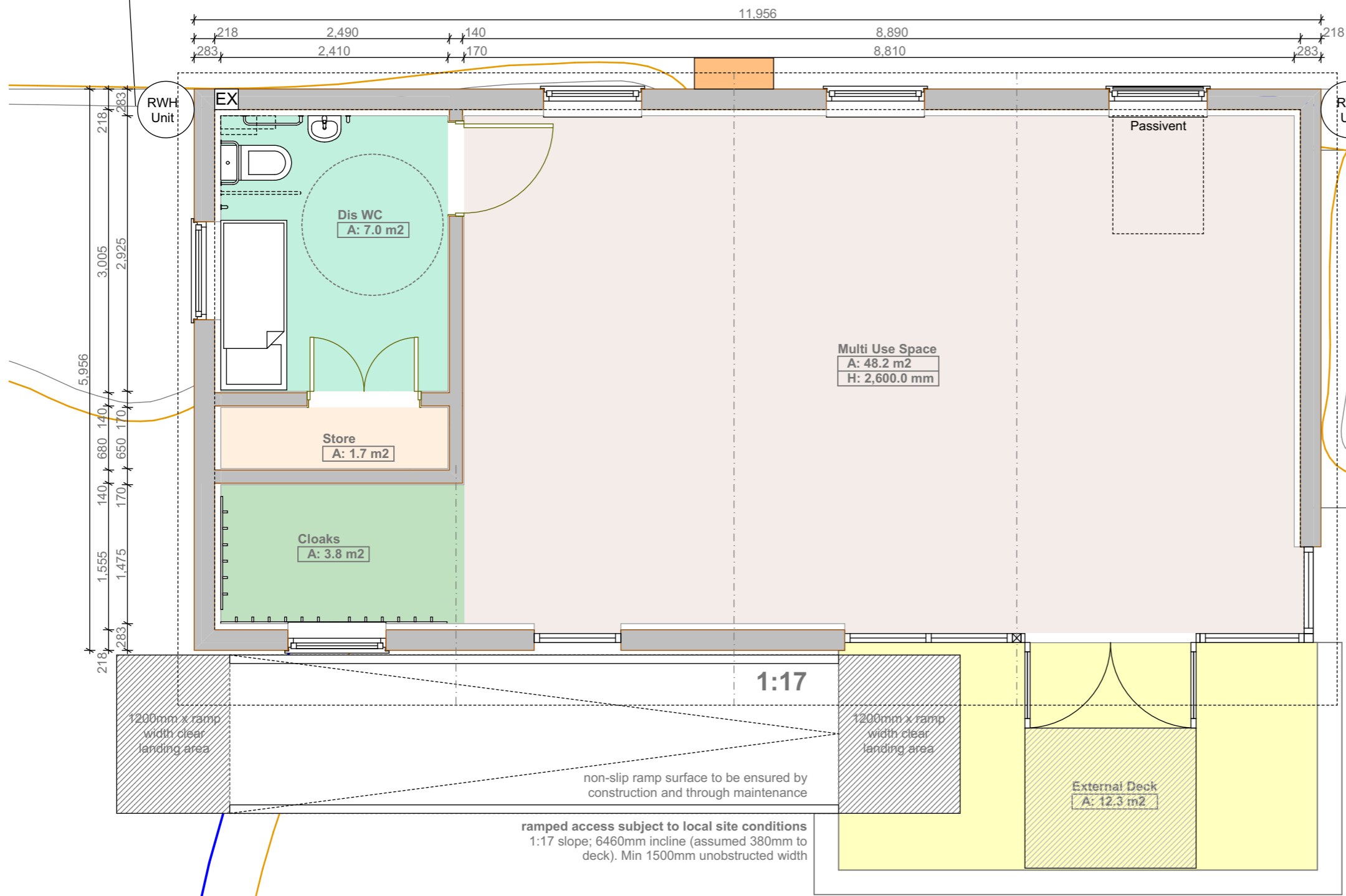

Vertical timber cladding.
Total Floor Area (including linings and partitions): 63.6sqm
Aluminium window frames.
Rainwater harvesting
Screw piles foundation
Site conditions are indicative only.
Indicative plan layout. Furniture shown for purposes of illustration.
Internal structural height: 2600mm
Classroom designed for: 8 pupils
SEN
Sedum roof.
Ventilation and Extract Equipment:
Extract Fan: To WC and kitchen areas.
Air Source Heating - external condensing unit: To provide space heating to main areas

Approximate location of existing trees

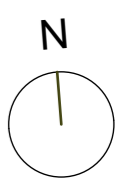

Rev.A: 04.02.20: G.C. Modified based on client's comments